

# #15009 Shaker Kitchen – Lower Corner Cabinet Kit

Step-by-step assembly instructions

Copyright miniatures.com 2024



## SUPPLIES NEEDED:

Masking tape  
White glue (such as #1249 Weldbond)  
Damp clean cloth  
Finishes

## GENERAL INSTRUCTIONS

- Identify and inspect all parts using the Parts Diagram.
- Read the directions completely before beginning the project.
- If possible, have a dedicated work area so that you are not unpacking, repacking, and moving the project from place to place.
- Choose a work surface that is level, clean, dry, and protected from glue spills.
- Do a dry fit, using masking tape to hold parts in place, to make sure everything fits together correctly before assembling permanently.

## Assembly Instructions

1. Place both **Backs** on the work surface side by side with their beveled edges facing down and touching. Add tape across where the two pieces join.
2. Turn the assembly over and add glue to the beveled edges. Close the pieces together and stand them up like a book. Support the joint by adding tape across the corners. Clean away excess glue inside the joint.
3. Orient the assembly with the shortest shelf space towards the bottom.

4. Glue the **Large Shelf** on the right side and into the center groove.
5. Glue the **L-Shelves** into the top and bottom rabbets. The **L-Shelves** are smaller than the cabinet top. Set aside.
6. Glue the **Square Shelf** to the groove on the **Dividing Wall**.
7. Glue this assembly to the left side of the cabinet assembly between the **L-Shelves**. The **Dividing Wall** touches the **Large Shelf**. All joints are flush.

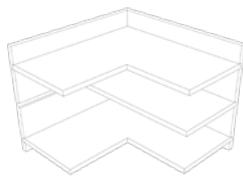

8. Glue the **Sides** to the outside edges of the **Shelves** and **Backs**. Orient their notches towards the bottom front. All joints are flush.
9. Glue the **Long Trim** to the front edges of the **Sides**. It is flush at the top edges.

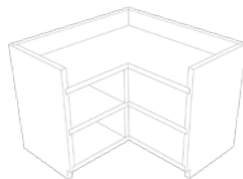

### Tips:

- The kit is precisely cut to fit together with minimal sanding, if any. Where needed, use a fine grit paper on a sanding block.
- A fine-tipped glue applicator (such as the Pinpoint Glue Syringe Kit #10244) can be helpful.
- Stain the cabinets before assembly or paint after assembly.
- All drawers in the collection fit together the same way. The sides attach around the base. All outside edges are flush. Fronts have two predrilled holes for hardware; they are flush at the bottom edge and rises above the drawer.
- All doors in the collection fit together the same way. The door framing fits around the door panel and the back is flat. The frame piece that is contoured and has a hole at either end goes on the hinge side. The hole on the surface of a frame piece is for the pull. Pulls are at the top for lower cabinets and the bottom for upper cabinets.
- To install door hinges, insert one pin in the hole at the top or side of the frame. Push the pin through and into the corresponding hole in the door. Adjust the door alignment as necessary for the holes to align. Insert another pin through on the other end.

10. Glue on the **Shorter Trim**. They go on the front edges of the top and bottom **Shelves** and are flush against the **Long Trim**. Assure that the hinge holes are oriented towards the outer edges.
11. Assemble and install the doors.
12. Glue on the **Top**. It is flush at the sides and back, and overhangs at the front.
13. Glue the **Corner Trim** to the inner corner. It touches the **Dividing Wall** and **Shelves**. It is flush with the bottom of the lower shelf.
14. Assemble and install the drawers. Sand lightly where necessary.
15. Glue the **Footings** at the bottom front edge. They go between the **Sides** and meet at the inner corner. **Short** butts against **Long**.

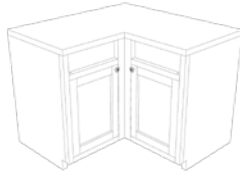

16. Glue the **Toe Kicks** at the bottom front edge. They cover the front edges of the **Sides** and meet at the inner corner. **Short** butts against **Long**.
17. Glue on the **Top**. It is flush at the back and overhangs at the front.
18. Glue on the **Counter**. It is flush at the back and overhangs at the front.
19. Finish as desired.

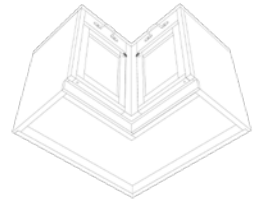

Assembly is now complete. Enjoy!

## Parts Diagram

Note: Not to scale



Vertical Trim (x2)



Knob (x2)



Pins (x4)



Drawer Handle (x2)



Short Footing

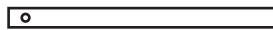

Horizontal Trim (x4)



Long Footing



Door Frame Short (x4)



Toe Kick (x2)



Drawer Front (x2)

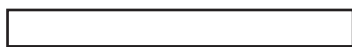

Door Frame Long (x2)

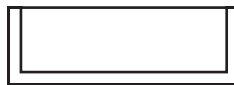

Drawer Back (x2)



Corner Trim

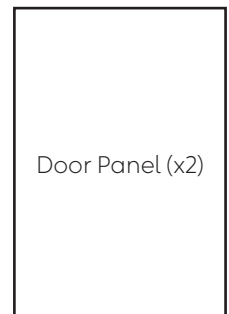

Door Panel (x2)

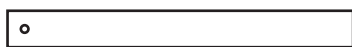

Door Frame Long (knob) (x2)



Drawer Sides (x4)

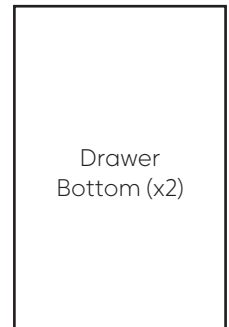

Drawer Bottom (x2)

